

OPTIONAL INTERCHANGEABLE ENDS OPTIONAL TERMINALI INTERCAMBIABILI

Terminali per misurazioni di passi:
 METRICO 0,8 - 1 - 1,25 - 1,5 - 1,75 - 2 - 2,5 - 3
 WITWORTH 6 - 8 - 10 - 12 - 16
 GAS 11 - 14 - 19

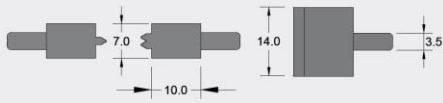

Article Code
 VP1 00209

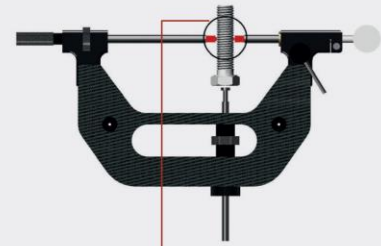
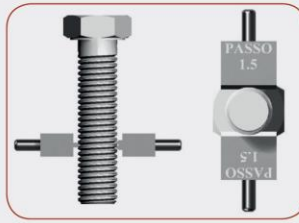

Terminali per controllo modulo filettature trapezio:

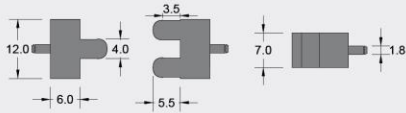

Article Code
 VP3 00216

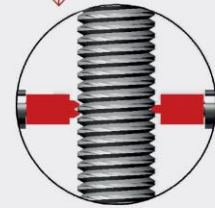
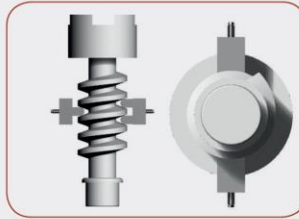

OPTIONAL INTERCHANGEABLE ENDS OPTIONAL TERMINALI INTERCAMBIABILI

RODS
 PUNTALI

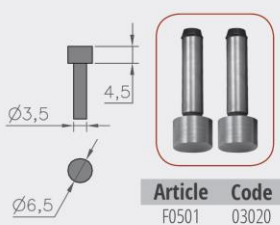

Article Code
 F0501 03020

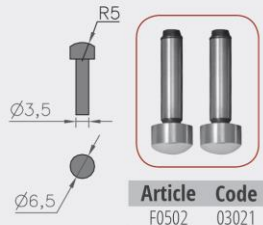

Article Code
 F0502 03021

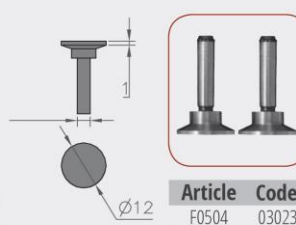

Article Code
 F0504 03023

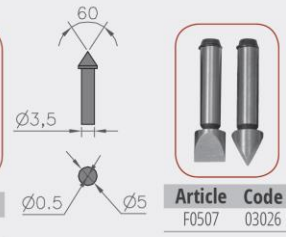

Article Code
 F0507 03026

TASTATORI
 TASTATORI

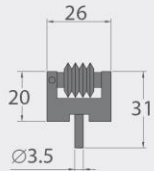

FOR INTERCHANGEABLE ENDS SEE PAG. 106 - 107
 PER I TERMINALI INTERCAMBIABILI VEDERE A PAG. 106 - 107

| Article | D | P. | Code | Kg |
|---------|----|------|-------|-------|
| ATZ08 | 14 | 0,8 | 00312 | 0,080 |
| ATZ1 | 14 | 1 | 00313 | 0,080 |
| ATZ125 | 14 | 1,25 | 00314 | 0,080 |
| ATZ15 | 14 | 1,5 | 00315 | 0,080 |
| ATZ2 | 14 | 2 | 00316 | 0,080 |
| ATZ25 | 14 | 2,5 | 00317 | 0,080 |
| ATZ3 | 14 | 3 | 00318 | 0,080 |
| ATZ4 | 20 | 4 | 00319 | 0,080 |
| ATZ5 | 20 | 5 | 00320 | 0,080 |
| ATZ6 | 20 | 6 | 00321 | 0,080 |